

DATE:

PROJECT

COMMENTS:

FEATURES

- NEMA 4X rating makes this ideal for use in outdoor and wet locations.
- Multi-Volt operation allows for 3.6V, 6.0V, 8.4V, 9.6V, or 12.0V products.
- Standard units use 1W per head and the High Lumen (HL) units use 1.5W per head.
- Black & gray options available with wet location (LW or LWP) option.



CLICK THE IMAGE TO VIEW ALTERNATE PRODUCT PHOTOS
Only available with Adobe Acrobat and Acrobat Reader

ORDERING INFORMATION MVH-BK-1

1. SERIES 2. HOUSING COLOR

MVH -

BK Black
GY Gray (Only Available with LW/LWP Option)
WH White (Not Available with LW/LWP Option)

3. HEAD COUNT 4. OPTIONS

1 One Lamp
2 Two Lamps

BLANK = NO OPTION

SD Self-Diagnostics

HO High-Output Lamps

LW Wet Location, Weatherproof (Not Available with WH Finish)

LWP Wet Location, Thermoplastic Construction (Not Available with WH Finish)

ACCESSORIES; ORDER SEPARATELY

- **WG-16.5LX14.0WX3.0D** = Wireguard, Length: 16.5", Width: 14", Depth: 3"
- **WG-16.5LX14.0WX6.0D** = Wireguard, Length: 16.5", Width: 14", Depth: 6"
- **WG-20.0LX19.0WX9.0D** = Wireguard, Length: 20", Width: 19", Depth: 9"
- **WG-26.0LX19.0WX9.0D** = Wireguard, Length: 26", Width: 19", Depth: 9"

SPECIFICATIONS

CONSTRUCTION

- High impact thermoplastic

APPROVALS

- NEMA 4X (with WP option only)
- IP66 (with WP option only)
- UL 924
- NFPA 101 Life Safety Code
- NFPA 70-NEC
- OSHA

WARRANTY

Isolite offers a 3-year limited warranty. For further details, refer to General Warranty and Obligations in the Isolite manual or on our website. Lamps not warranted.

DIMENSIONS

MVH - WET LOCATION

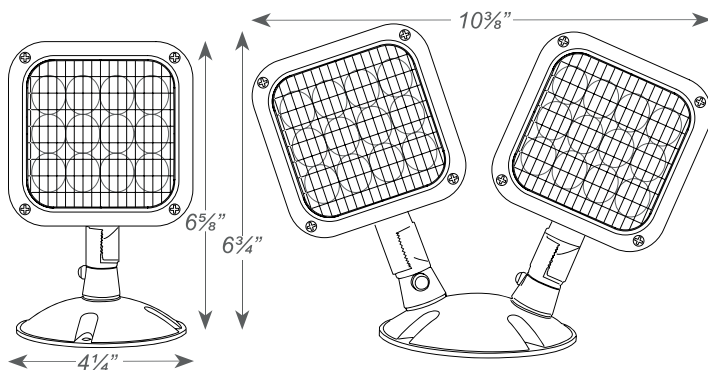

MVH

